

**This electronic collection of documents is provided
for the convenience of the user
and is Not a Certified Document –**

**The documents contained herein were originally issued
and sealed by the individuals whose names and license
numbers appear on each page, on the dates appearing
with their signature on that page.**

**This file or an individual page
shall not be considered a certified document.**

STATE OF NORTH CAROLINA DIVISION OF HIGHWAYS

SWAIN/JACKSON COUNTY

STATE	STATE PROJECT REFERENCE NO.	SHEET NO.	TOTAL SHEETS
N.C.	DN01056	1	
STATE PROJ. NO.	F. A. PROJ. NO.	DESCRIPTION	
49336.1.27	4933604	P.E.	
49336.3.27	4933604	CONSTRUCTION	
49336.1.31	4933608	P.E.	
49336.3.31	4933608	CONSTRUCTION	

LOCATION: *SR 1337 (DEEP CREEK RD)*
SR 1356 (SAVANNAH DR)

TYPE OF WORK: *SIDEWALK, CURB RAMPS,*
PAVEMENT MARKINGS

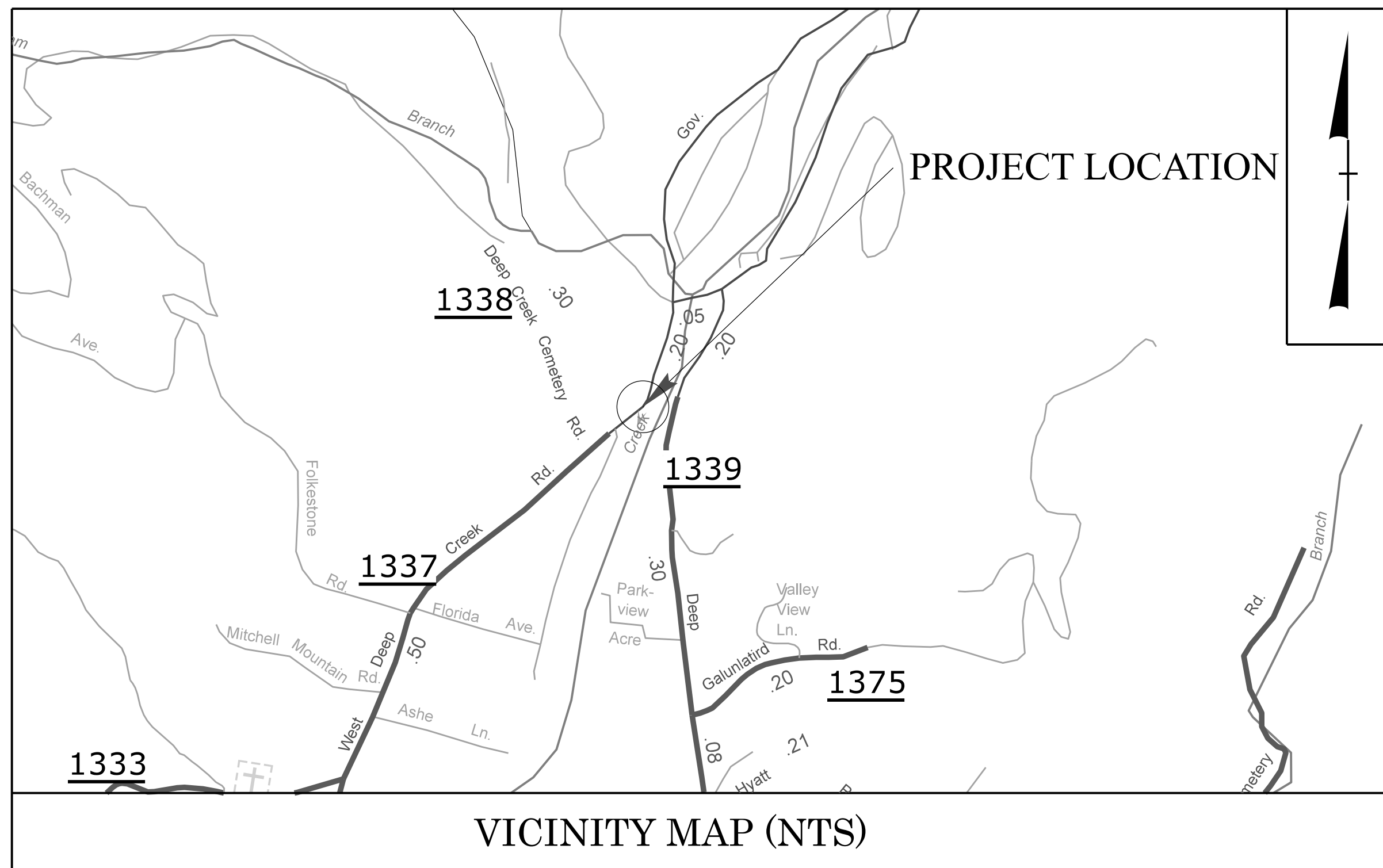

VICINITY MAP (NTS)

HS-2014Z

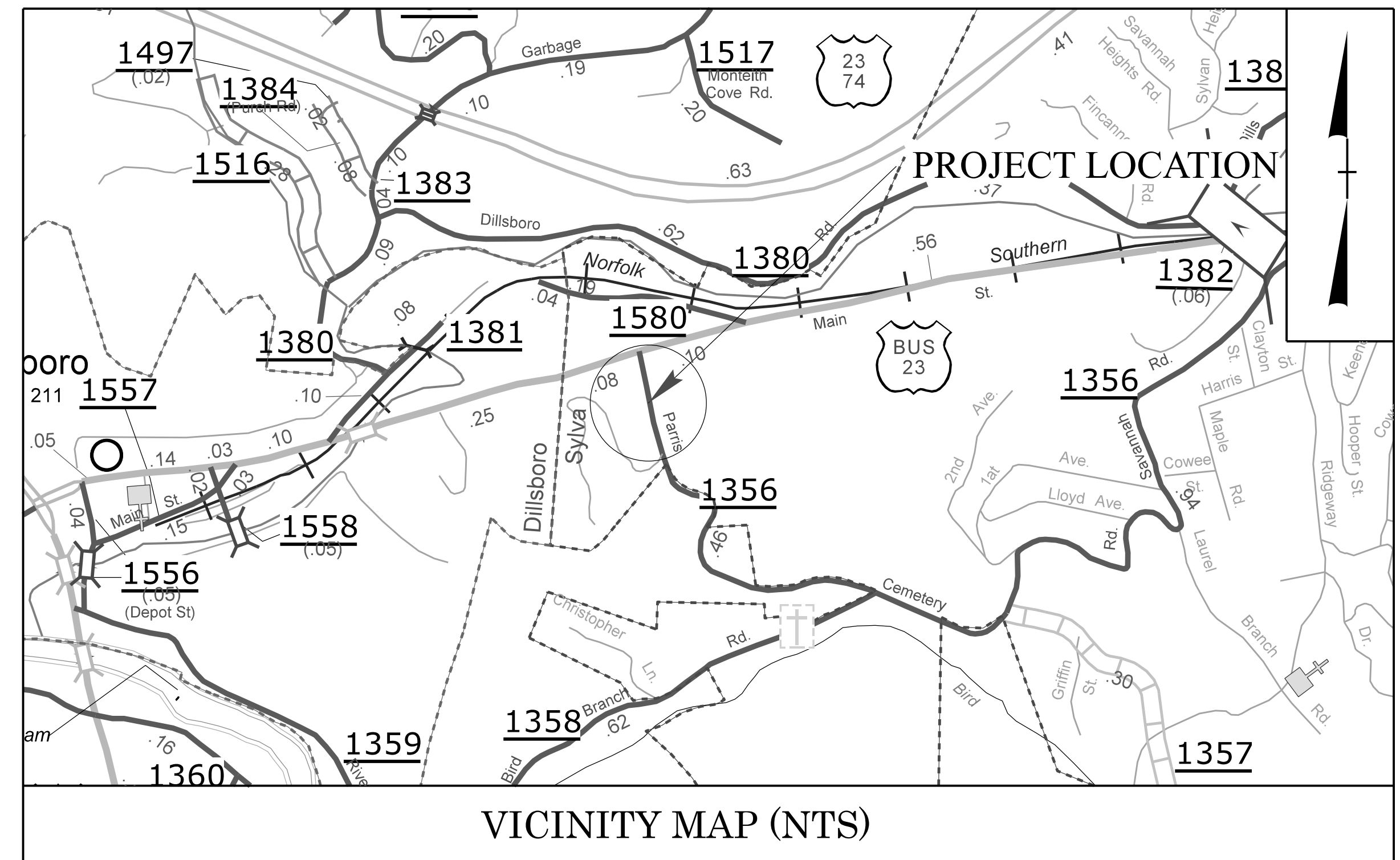

VICINITY MAP (NTS)

HS-2014AD

DOCUMENT NOT CONSIDERED FINAL
UNLESS ALL SIGNATURES COMPLETED

CONTRACT: DN01056

GRAPHIC SCALES

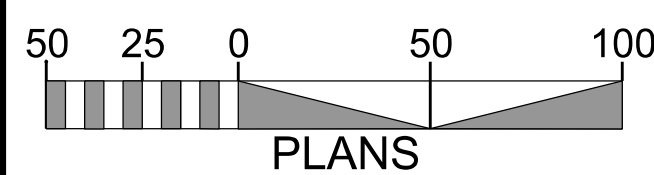

PROJECT LENGTH

TOTAL LENGTH OF TIP HS-2014Z : 0.018 MILES
TOTAL LENGTH OF TIP HS-2014AD ; 0.112 MILES

Prepared in the Office of:
DIVISION OF HIGHWAYS
253 Webster Rd., Sylva NC, 28779

2024 STANDARD SPECIFICATIONS

RIGHT OF WAY DATE: **JAMES HOLLINGSWORTH, PE**
PROJECT ENGINEER
N/A

LETTING DATE: **JAMES HOLLINGSWORTH, PE**
PROJECT DESIGN ENGINEER
SEPTEMBER 9, 2025

HYDRAULICS ENGINEER

7/7/2025

DocuSigned by:
James Hollingsworth P.E.
SIGNATURE:

ROADWAY DESIGN ENGINEER

7/7/2025

DocuSigned by:
James Hollingsworth P.E.
SIGNATURE:

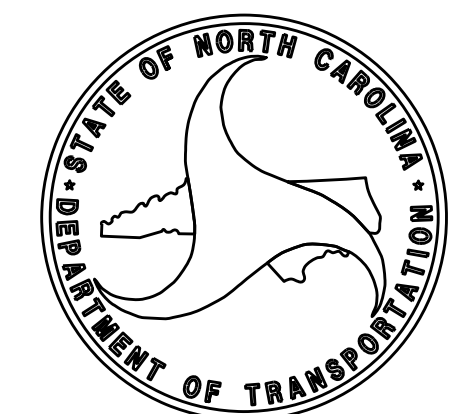

See Sheet 1A For Index of Sheets
See Sheet 1B For Conventional Plan Sheet Symbols

STATE OF NORTH CAROLINA DIVISION OF HIGHWAYS

SWAIN COUNTY

LOCATION: *SR 1337 (DEEP CREEK RD).*
NEAR SR 1336

TYPE OF WORK: *SIDEWALK, CURB RAMPS,*
PAVEMENT MARKINGS

STATE	STATE PROJECT REFERENCE NO.	SHEET NO.	TOTAL SHEETS
N.C.	HS-2014Z	1	
STATE PROJ. NO.	F. A. PROJ. NO.	DESCRIPTION	
49336.1.27	4933604	P.E.	
49336.3.27	4933604	CONSTRUCTION	

TIP PROJECT: HS-2014Z

CONTRACT: DN01056

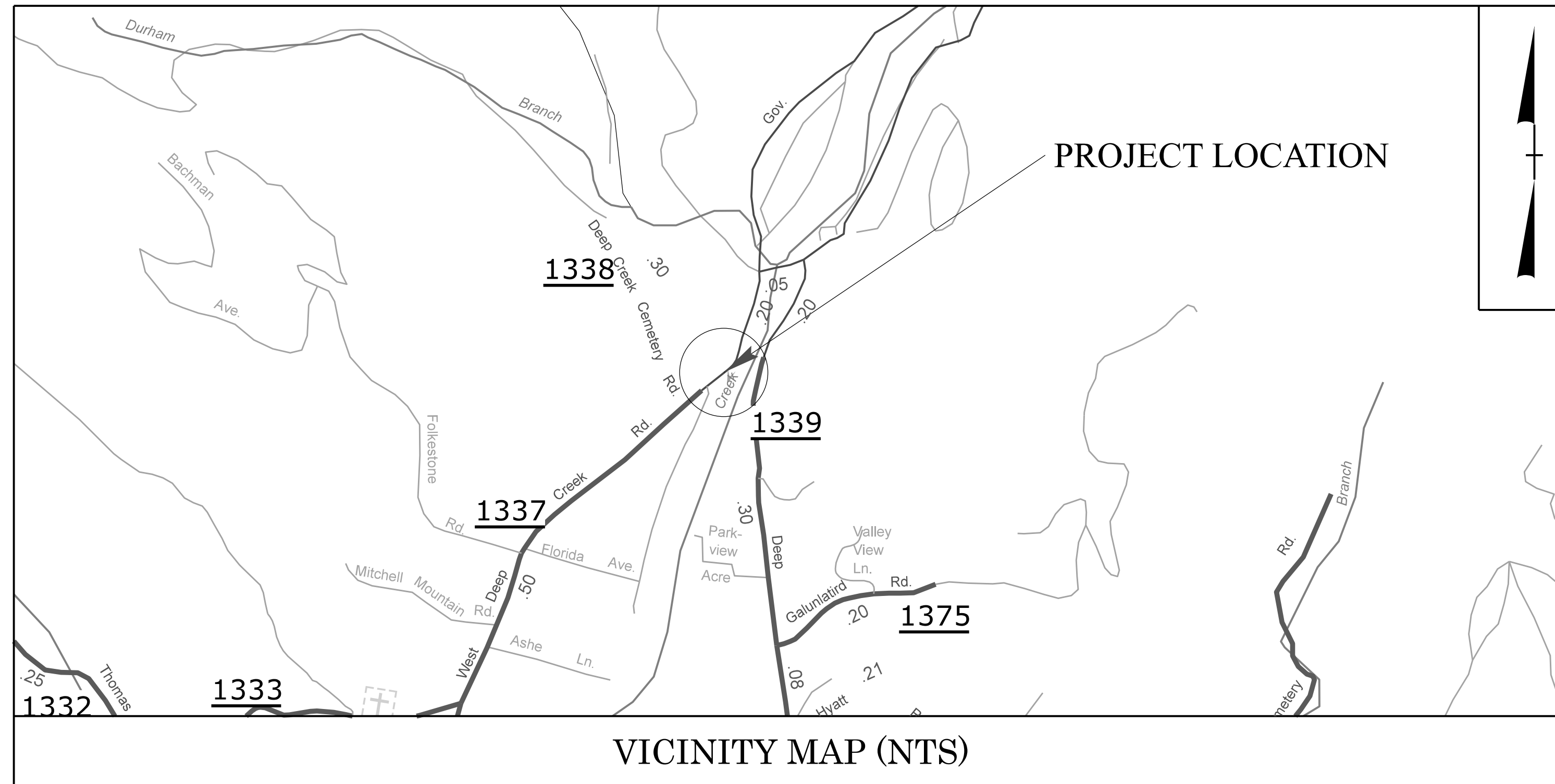

DOCUMENT NOT CONSIDERED FINAL
UNLESS ALL SIGNATURES COMPLETED

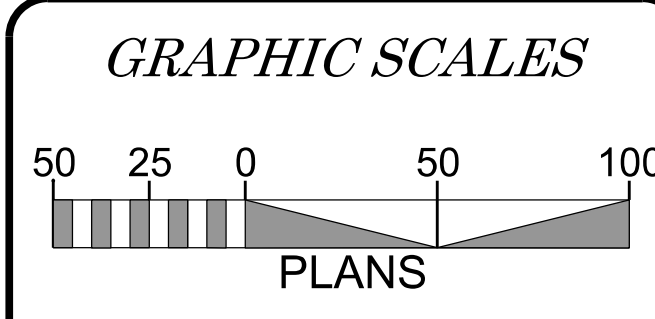

PROJECT LENGTH

TOTAL LENGTH OF TIP PROJECT HS-2014Z = 0.018 MILES

Prepared in the Office of:
DIVISION OF HIGHWAYS
253 Webster Rd., Sylva NC, 28779

2024 STANDARD SPECIFICATIONS

RIGHT OF WAY DATE: N/A

LETTING DATE: SEPTEMBER 9, 2025

JAMES HOLLINGSWORTH, PE
PROJECT ENGINEER

JAMES HOLLINGSWORTH, PE
PROJECT DESIGN ENGINEER

HYDRAULICS ENGINEER
7/7/2025

DocuSigned by:
James Hollingsworth
SIGNATURE: P.E.

ROADWAY DESIGN ENGINEER
7/7/2025

DocuSigned by:
James Hollingsworth
SIGNATURE: P.E.

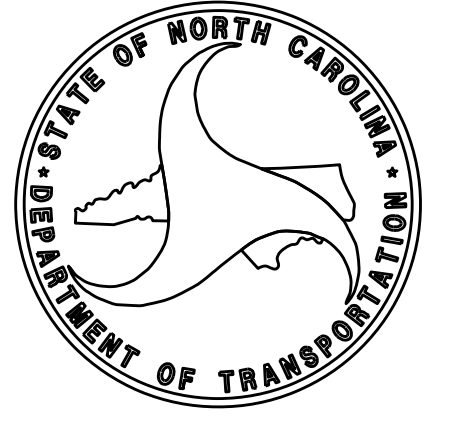

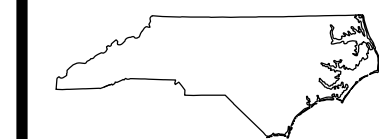

INDEX OF SHEETS

SHEET NUMBER	SHEET
1	TITLE SHEET
1A	INDEX OF SHEETS, GENERAL NOTES, AND STANDARD DRAWINGS
1B	CONVENTIONAL SYMBOLS
2A	TYPICAL SECTIONS
2B	ROADWAY DETAIL
4	PLAN SHEET

GENERAL NOTES: 2024 SPECIFICATIONS
 EFFECTIVE: 01-16-2024
 REVISED:

GRADING AND SURFACING OR RESURFACING AND WIDENING:
 THE GRADE LINES SHOWN DENOTE THE FINISHED ELEVATION OF THE PROPOSED SURFACING AT GRADE POINTS SHOWN ON THE TYPICAL SECTIONS. WHERE NO GRADE LINES ARE SHOWN, THE PROFILES SHOWN DENOTE THE TOP ELEVATION OF THE EXISTING PAVEMENT ALONG THE CENTER LINE OF SURVEY ON WHICH THE PROPOSED RESURFACING WILL BE PLACED. GRADE LINES MAY BE ADJUSTED BY THE ENGINEER IN ORDER TO SECURE A PROPER TIE-IN.

SIDE ROADS:
 THE CONTRACTOR WILL BE REQUIRED TO DO ALL NECESSARY WORK TO PROVIDE SUITABLE CONNECTIONS WITH ALL ROADS, STREETS, AND DRIVES ENTERING THIS PROJECT. THIS WORK WILL BE PAID FOR AT THE CONTRACT UNIT PRICE FOR THE PARTICULAR ITEMS INVOLVED.

UTILITIES:
 ANY RELOCATION OF EXISTING UTILITIES WILL BE ACCOMPLISHED BY OTHERS, EXCEPT AS SHOWN ON THE PLANS.

CURB RAMPS
 CURB RAMPS ARE SHOWN ON THE PLANS AT APPROXIMATE LOCATIONS. CONSTRUCT ALL CURB RAMPS ACCORDANCE WITH STD 848.06.

DO NOT ENTER NATIONAL PARK PROPERTY
 NCDOT TO INSTALL RRFB'S SIGNALS AND PEDESTALS AFTER PROJECT COMPLETION

EFF. 01-16-2024
 REV.
 2024 ROADWAY ENGLISH STANDARD DRAWINGS

The following Roadway Standards as appear in "Roadway Standard Drawings" Contracts Standards and Development Unit - N. C. Department of Transportation - Raleigh, N. C., Dated January 16, 2024 are applicable to this project and by reference hereby are considered a part of these plans:

STD.NO.	TITLE
DIVISION 8 - INCIDENTALS	
838.01	Concrete Endwall for Single and Double Pipe Culverts - 15" thru 48" Pipe 90 Skew
848.01	Concrete Sidewalk
848.06	Curb Ramp
DIVISION 11 - WORK ZONE TRAFFIC CONTROL	
1101.01	Work Zone Advance Warning Signs
1101.02	Temporary Lane Closures
1101.03	Temporary Road Closures
1101.04	Temporary Shoulder Closures
1101.05	Work Zone Vehicle Accesses
1101.06	Warning Signs for Blasting Zones
1101.11	Traffic Control Design Tables
1110.01	Stationary Work Zone Signs
1110.02	Portable Work Zone Signs
1115.01	Flashing Arrow Boards
1130.01	Drums
1135.01	Cones
1145.01	Barricades - Type III
1150.01	Flaggers
1160.01	Temporary Crash Cushion - Reflective End Treatment
1165.01	Truck Mounted Attenuator
1170.01	Portable Concrete Barrier
1180.01	Skinny Drums
DIVISION 12 - PAVEMENT MARKINGS, MARKERS AND DELINEATIONS	
1205.01	Line Types and Offsets
1205.02	Two Lane and Multi Lane Roadways
1205.07	Pedestrian Crosswalks
DIVISION 15 - UTILITIES	
1515.01	Water Meter
1515.02	Fire Hydrant
1525.02	Precast Concrete Sanitary Sewer Manhole - Outside Drop

STATE OF NORTH CAROLINA, DIVISION OF HIGHWAYS CONVENTIONAL PLAN SHEET SYMBOLS

Note: Not to Scale

BOUNDARIES AND PROPERTY:

State Line	-----
County Line	-----
Township Line	-----
City Line	-----
Reservation Line	-----
Property Line	-----
Existing Iron Pin (EIP)	----- ○ EIP
Computed Property Corner	----- X
Existing Concrete Monument (ECM)	----- ◻ ECM
Parcel / Sequence Number	----- ●
Existing Fence Line	----- x-x-x-x
Proposed Woven Wire Fence	----- ●
Proposed Chain Link Fence	----- ■
Proposed Barbed Wire Fence	----- ◆
Existing Wetland Boundary	----- -MLB-
Proposed Wetland Boundary	----- MLB
Existing Endangered Animal Boundary	----- EAB
Existing Endangered Plant Boundary	----- EPB
Existing Historic Property Boundary	----- HPB
Known Contamination Area: Soil	----- -S-S-
Potential Contamination Area: Soil	----- -S-S-
Known Contamination Area: Water	----- -W-W-
Potential Contamination Area: Water	----- -W-W-
Contaminated Site: Known or Potential	----- ☠ ☠

BUILDINGS AND OTHER CULTURE:

Gas Pump Vent or U/G Tank Cap	----- ○
Sign	----- ○
Well	----- ○
Small Mine	----- X
Foundation	----- ■
Area Outline	----- ■
Cemetery	----- ■
Building	----- ■
School	----- ■
Church	----- ■
Dam	----- ■

HYDROLOGY:

Stream or Body of Water	-----
Hydro, Pool or Reservoir	----- ◻
Jurisdictional Stream	----- JS
Buffer Zone 1	----- BZ 1
Buffer Zone 2	----- BZ 2
Flow Arrow	----- ←
Disappearing Stream	----- >
Spring	----- ○
Wetland	----- ⊥
Proposed Lateral, Tail, Head Ditch	-----
False Sump	----- ◻

RAILROADS:

Standard Gauge	-----
RR Signal Milepost	----- ○
Switch	----- ■
RR Abandoned	----- - - - -
RR Dismantled	----- - - - -

RIGHT OF WAY & PROJECT CONTROL:

Primary Horiz Control Point	----- ◻
Primary Horiz and Vert Control Point	----- ●
Secondary Horiz and Vert Control Point	----- ◆
Vertical Benchmark	----- ⊠
Existing Right of Way Monument	----- △
Proposed Right of Way Monument (Rebar and Cap)	----- ▲
Proposed Right of Way Monument (Concrete)	----- ●
Existing Permanent Easement Monument	----- ◊
Proposed Permanent Easement Monument (Rebar and Cap)	----- ◊
Existing C/A Monument	----- ▲
Proposed C/A Monument (Rebar and Cap)	----- ▲
Proposed C/A Monument (Concrete)	----- ●
Existing Right of Way Line	-----
Proposed Right of Way Line	----- ●
Existing Control of Access Line	----- (C/A)
Proposed Control of Access Line	----- ●
Proposed ROW and CA Line	----- ●
Existing Easement Line	----- E
Proposed Temporary Construction Easement	----- E
Proposed Temporary Drainage Easement	----- TDE
Proposed Permanent Drainage Easement	----- PDE
Proposed Permanent Drainage/Utility Easement	----- DUE
Proposed Permanent Utility Easement	----- PUE
Proposed Temporary Utility Easement	----- TUE
Proposed Aerial Utility Easement	----- AUE

ROADS AND RELATED FEATURES:

Existing Edge of Pavement	-----
Existing Curb	-----
Proposed Slope Stakes Cut	----- C
Proposed Slope Stakes Fill	----- F
Proposed Curb Ramp	----- CR
Existing Metal Guardrail	-----
Proposed Guardrail	-----
Existing Cable Guiderail	-----
Proposed Cable Guiderail	-----
Equality Symbol	----- ⊕
Pavement Removal	----- ■

VEGETATION:

Single Tree	----- ☼
Single Shrub	----- ☼
Hedge	-----

Woods Line	-----
Orchard	----- ☼ ☼ ☼ ☼
Vineyard	----- Vineyard

EXISTING STRUCTURES:

MAJOR:	
Bridge, Tunnel or Box Culvert	----- CONC
Bridge Wing Wall, Head Wall and End Wall	-----) CONC WW (
MINOR:	
Head and End Wall	----- CONC HW
Pipe Culvert	-----
Footbridge	-----
Drainage Box: Catch Basin, DI or JB	----- CB
Paved Ditch Gutter	-----
Storm Sewer Manhole	----- S
Storm Sewer	----- S

UTILITIES:

* SUE - Subsurface Utility Engineering
LOS - Level of Service - A,B,C or D (Accuracy)

POWER:	
Existing Power Pole	----- ●
Proposed Power Pole	----- ●
Existing Joint Use Pole	----- ●
Proposed Joint Use Pole	----- ●
Power Manhole	----- ⊕
Power Line Tower	----- ⊠
Power Transformer	----- ⊠
U/G Power Cable Hand Hole	----- PH
H-Frame Pole	----- ●
U/G Power Line Test Hole (SUE - LOS A)*	----- ⊕
U/G Power Line (SUE - LOS B)*	----- P
U/G Power Line (SUE - LOS C)*	----- P
U/G Power Line (SUE - LOS D)*	----- P

TELEPHONE:

Existing Telephone Pole	----- ●
Proposed Telephone Pole	----- ●
Telephone Manhole	----- ⊕
Telephone Pedestal	----- ⊠
Telephone Cell Tower	----- ⊠
U/G Telephone Cable Hand Hole	----- PH
U/G Telephone Test Hole (SUE - LOS A)*	----- ⊕
U/G Telephone Cable (SUE - LOS B)*	----- T
U/G Telephone Cable (SUE - LOS C)*	----- T
U/G Telephone Cable (SUE - LOS D)*	----- T
U/G Telephone Conduit (SUE - LOS B)*	----- TC
U/G Telephone Conduit (SUE - LOS C)*	----- TC
U/G Telephone Conduit (SUE - LOS D)*	----- TC
U/G Fiber Optics Cable (SUE - LOS B)*	----- T FO
U/G Fiber Optics Cable (SUE - LOS C)*	----- T FO
U/G Fiber Optics Cable (SUE - LOS D)*	----- T FO

WATER:

Water Manhole	----- ⊕
Water Meter	----- ○
Water Valve	----- ⊗
Water Hydrant	----- ⊕
U/G Water Line Test Hole (SUE - LOS A)*	----- ⊕
U/G Water Line (SUE - LOS B)*	-----
U/G Water Line (SUE - LOS C)*	-----
U/G Water Line (SUE - LOS D)*	-----
Above Ground Water Line	----- A/G Water

TV:

TV Pedestal	----- ⊠
TV Tower	----- ⊗
U/G TV Cable Hand Hole	----- PH
U/G TV Test Hole (SUE - LOS A)*	----- ⊕
U/G TV Cable (SUE - LOS B)*	----- TV
U/G TV Cable (SUE - LOS C)*	----- TV
U/G TV Cable (SUE - LOS D)*	----- TV
U/G Fiber Optic Cable (SUE - LOS B)*	----- TV FO
U/G Fiber Optic Cable (SUE - LOS C)*	----- TV FO
U/G Fiber Optic Cable (SUE - LOS D)*	----- TV FO

GAS:

Gas Valve	----- ◊
Gas Meter	----- ⊕
U/G Gas Line Test Hole (SUE - LOS A)*	----- ⊕
U/G Gas Line (SUE - LOS B)*	----- G
U/G Gas Line (SUE - LOS C)*	----- G
U/G Gas Line (SUE - LOS D)*	----- G
Above Ground Gas Line	----- A/G Gas

SANITARY SEWER:

Sanitary Sewer Manhole	----- ⊕
Sanitary Sewer Cleanout	----- ⊕
U/G Sanitary Sewer Line	----- SS
Above Ground Sanitary Sewer	----- A/G Sanitary Sewer
SS Force Main Line Test Hole (SUE - LOS A)*	----- ⊕
SS Force Main Line (SUE - LOS B)*	----- FSS
SS Force Main Line (SUE - LOS C)*	----- FSS
SS Force Main Line (SUE - LOS D)*	----- FSS

MISCELLANEOUS:

Utility Pole	----- ●
Utility Pole with Base	----- ⊠
Utility Located Object	----- ○
Utility Traffic Signal Box	----- ⊠
Utility Unknown U/G Line (SUE - LOS B)*	----- ?UTL
U/G Tank; Water, Gas, Oil	----- ◻
Underground Storage Tank, Approx. Loc.	----- UST
A/G Tank; Water, Gas, Oil	----- ◻
Geoenvironmental Boring	----- ●
Abandoned According to Utility Records	----- AATUR
End of Information	----- E.O.I.

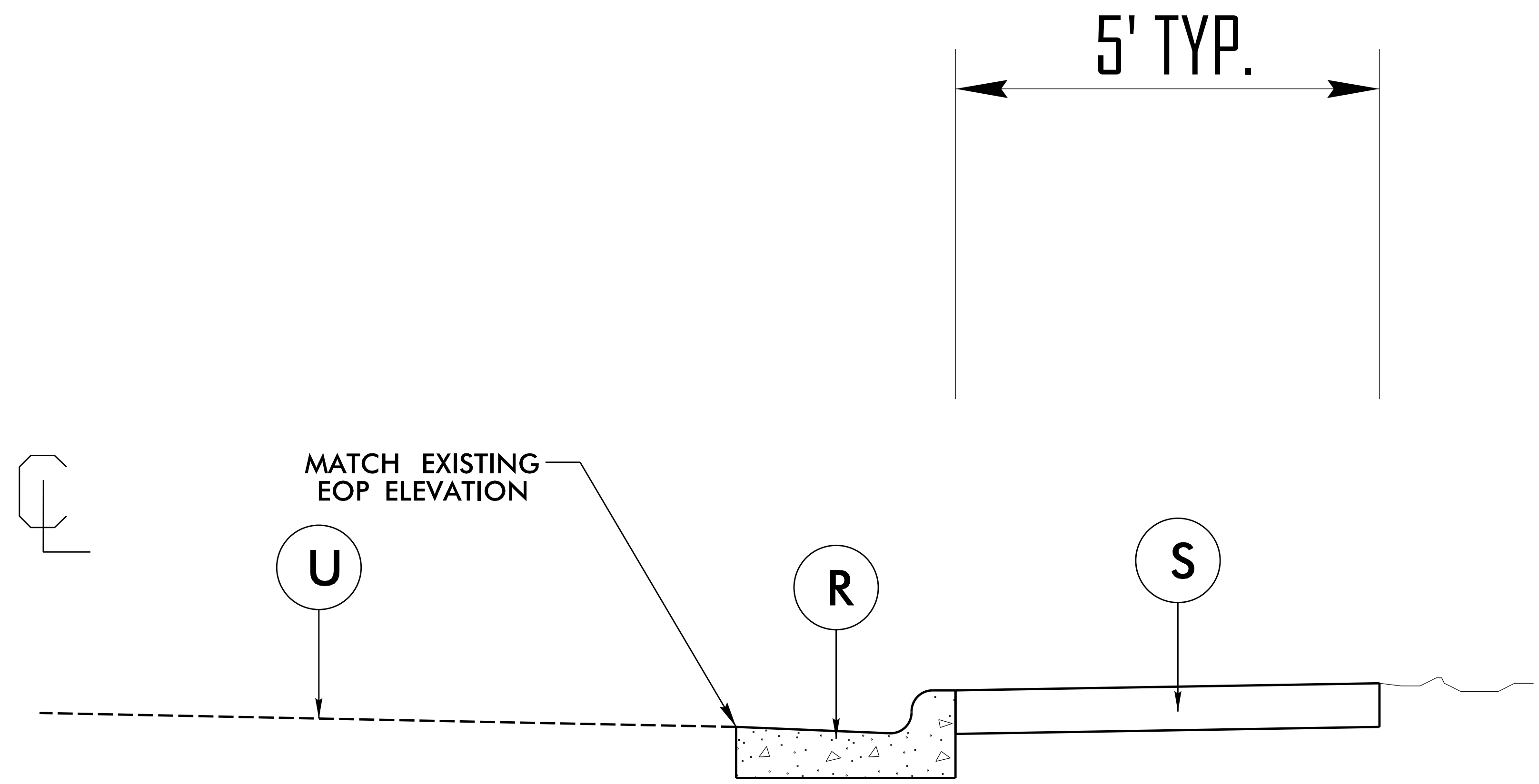

TYPICAL SECTION NO. 1

BEGIN TO END

PAVEMENT SCHEDULE	
R	2' - 6" CONCRETE CURB AND GUTTER
S	4" CONCRETE SIDEWALK
U	EXISTING PAVEMENT

HS-2014Z
2A

NORTH CAROLINA
DEPARTMENT OF TRANSPORTATION

ROADWAY DESIGN UNIT
ROADWAY DESIGN
ENGINEER

1/6/2025

HYDRAULICS
ENGINEER

1/6/2025

DOCUMENT NOT CONSIDERED FINAL
UNLESS ALL SIGNATURES COMPLETED

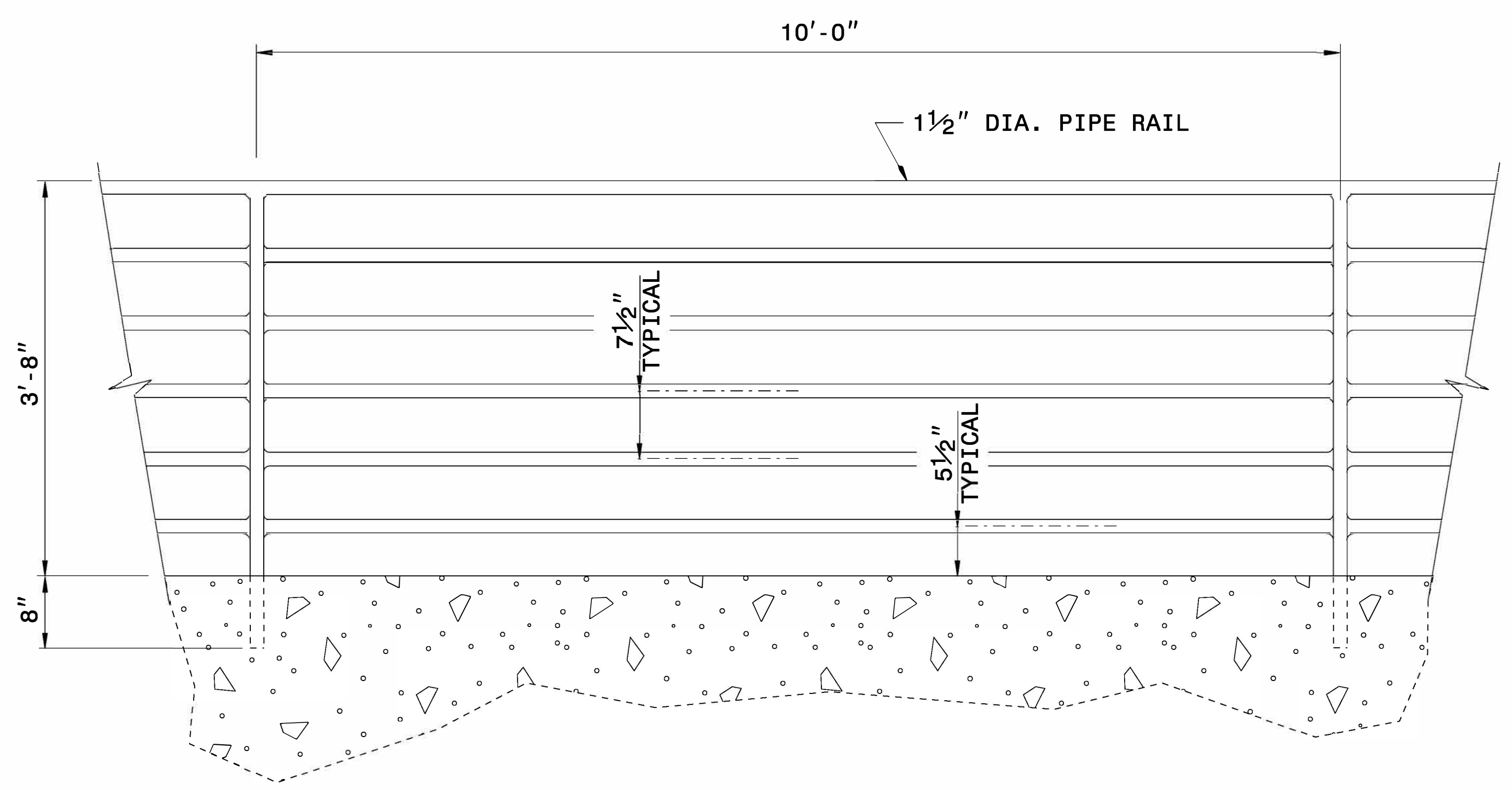

ELEVATION OF HANDRAIL

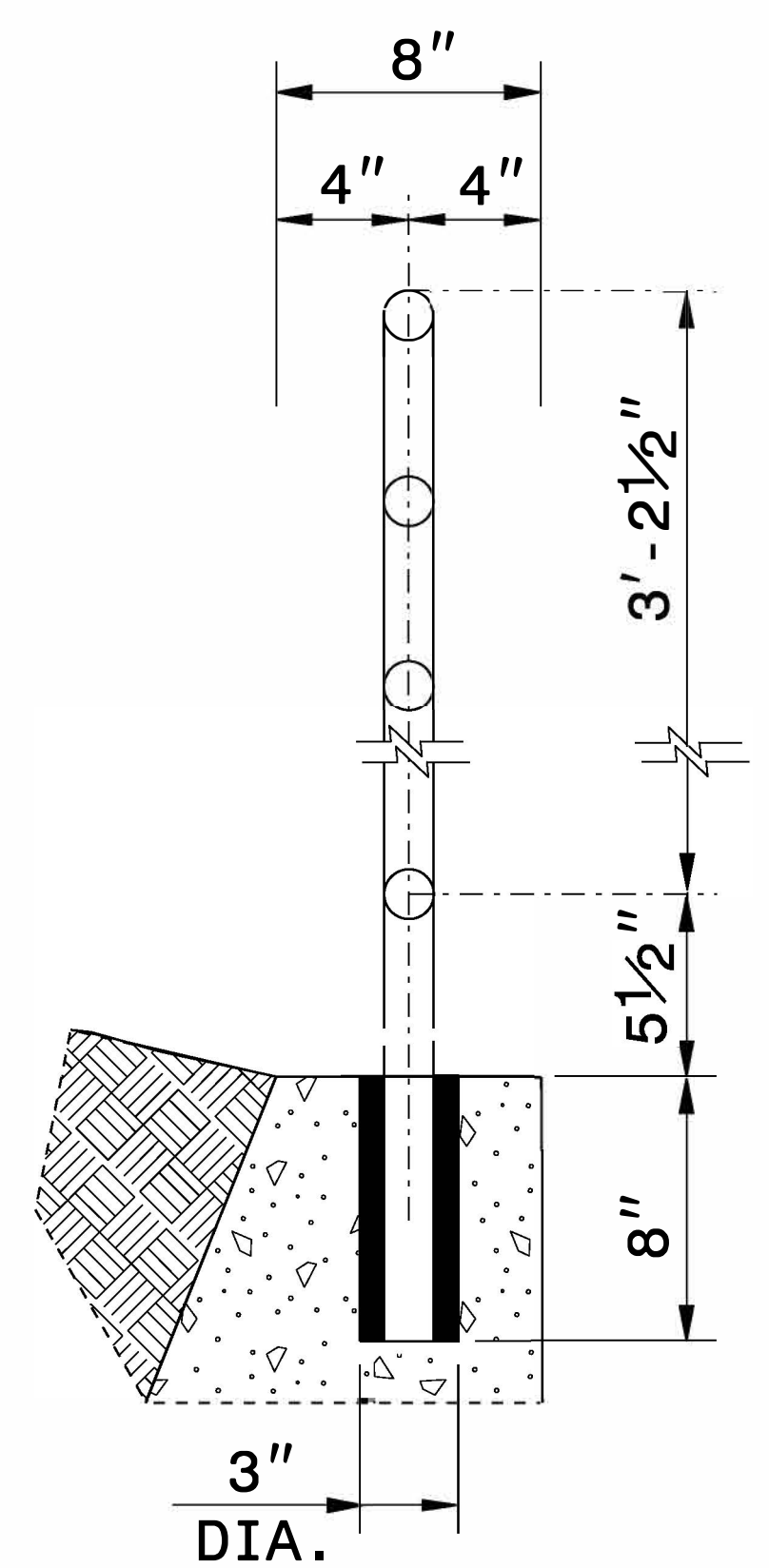

INSET 'A'

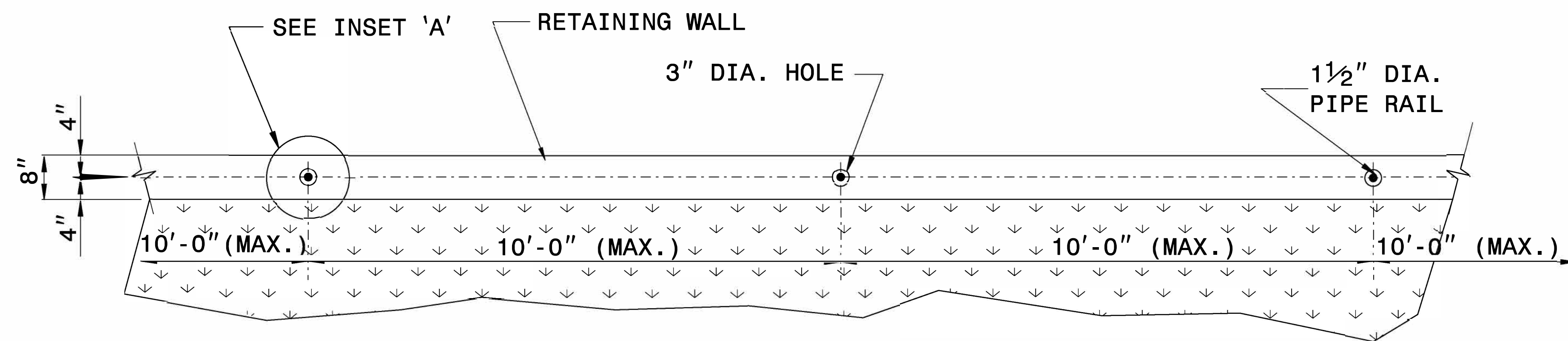

PLAN VIEW

NOTES:

- CONSTRUCT PROPOSED STEEL PIPE RAIL 1 1/2" DIAMETER SCHEDULE 40 PLAIN END GALVANIZED STEEL PIPE MEETING THE REQUIREMENTS OF ASTM A53.
- EMBED PIPE RAIL 8" INTO PROPOSED WALL WITH CHEMICAL OR CONCRETE GROUT ANCHORING SYSTEM AS DIRECTED BY THE ENGINEER.
- REPAIR GALVANIZING IN ACCORDANCE WITH SECTION 1076 OF THE NCDOT STANDARD SPECIFICATIONS.
- PAINT, IF REQUIRED BY THE ENGINEER, IN ACCORDANCE WITH SECTION 1080 OF THE STANDARD SPECIFICATIONS.
- CENTER THE PROPOSED RAILING ON TOP OF THE WALL WITH POST SPACING SYMMETRICAL ABOUT THE CENTER-LINE OF THE WALL.
- USE A ROTARY DRILL IF NEEDED FOR EMBEDMENT HOLES OF RAIL IN WALL. ROTARY DRILL ONLY (NO ROTARY-IMPACT DRILLS).
- WELD IN ACCORDANCE WITH ARTICLE 1072-18 OF THE STANDARD SPECIFICATIONS.

DATE PLOTTED: 12/15/09 10:58 AM
DRAWN BY: JUS/ERN/AVE
CHECKED BY: JUS/ERN/AVE
DATE: 12/15/09 10:58 AM



CONTRACT STANDARDS AND DEVELOPMENT UNIT	
Office 919-707-6950 FAX 919-250-4119	
DETAIL OF PIPE HANDRAIL MOUNTED ON RETAINING WALL	
ORIGINAL BY: E.E. WARD	DATE: 12-99
MODIFIED BY:	DATE:
CHECKED BY:	DATE:
FILE SPEC.: jhowerton/handrail on retaining wall.dgn	

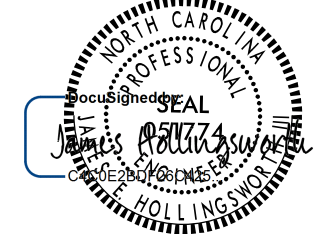
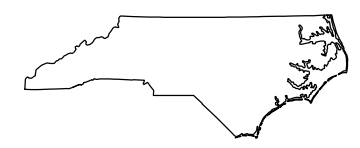

1/6/2025

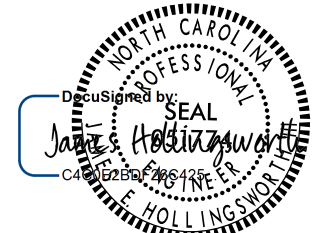

1/6/2025

DOCUMENT NOT CONSIDERED FINAL
UNLESS ALL SIGNATURES COMPLETED



PROP 2' - 6" CURB AND GUTTER

PROP 5' SIDEWALK

RELOCATE FIRE HYDRANT

ADJUST MANHOLE

ADJUST VALVE

CR

CR

CR

BEGIN SIDEWALK

INSTALL PEDESTRIAN SAFETY RAIL

PROP CULVERT ENDWALL

HI-VISIBILITY CROSSWALK
RSD 1205.07

END SIDEWALK

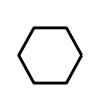

Type II Signal Pedestal w/ RRFB

09/08/09

TIP PROJECT: HS-2014AD

CONTRACT: DN01056

See Sheet 1A For Index of Sheets
See Sheet 1B For Conventional Plan Sheet Symbols

STATE OF NORTH CAROLINA DIVISION OF HIGHWAYS

JACKSON COUNTY

LOCATION: *SR 1356 (SAVANNAH DR) FROM US 23 BUS TO NICOL ARMS RD*

TYPE OF WORK: *CURB RAMPS, PAVEMENT MARKINGS,
SIDEWALK*

STATE	STATE PROJECT REFERENCE NO.	SHEET NO.	TOTAL SHEETS
N.C.	HS-2014AD	1	
STATE PROJ. NO.	F. A. PROJ. NO.	DESCRIPTION	
49336.1.31	4933608	P.E.	
49336.3.31	4933608	CONSTRUCTION	

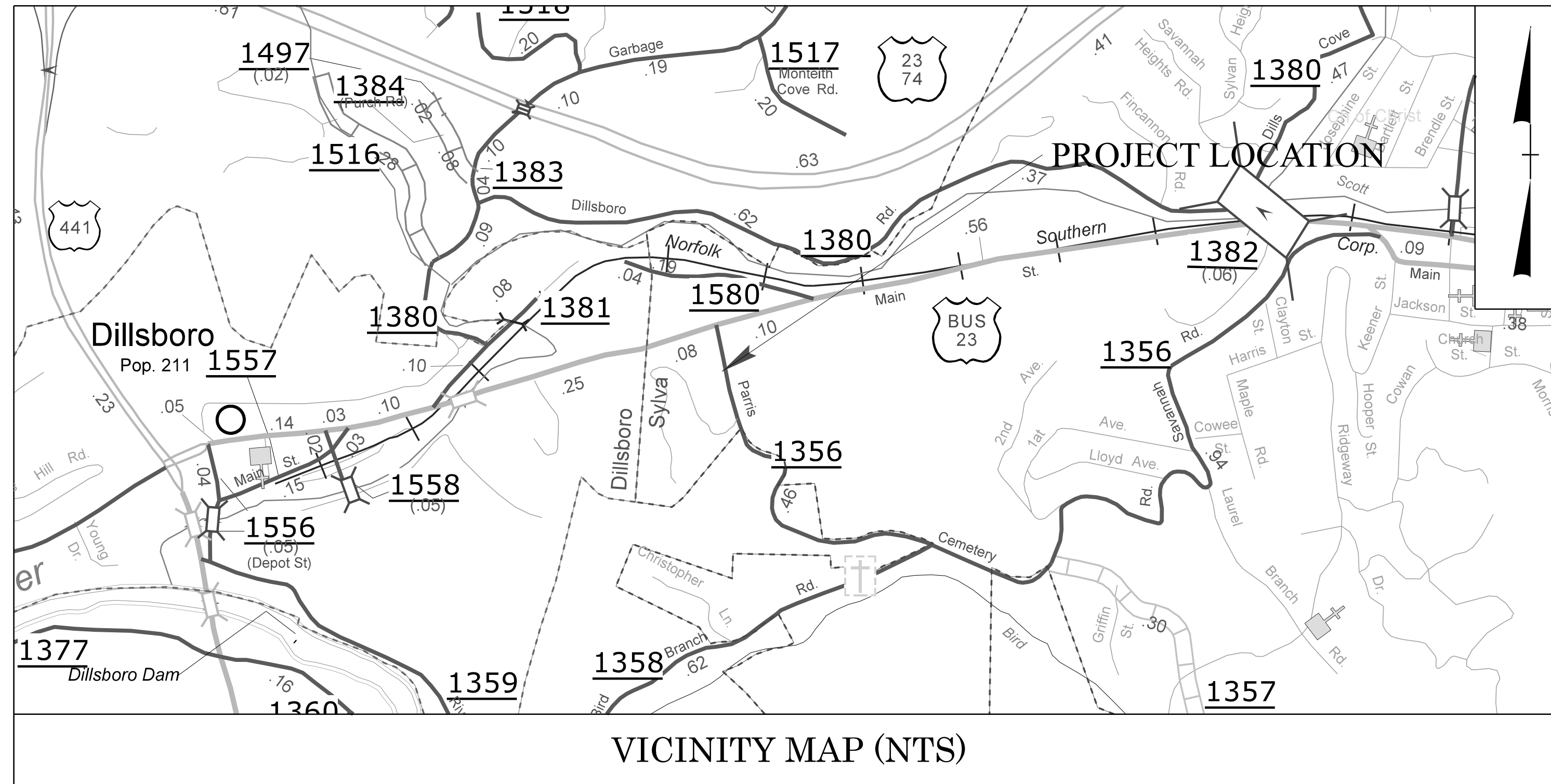

DOCUMENT NOT CONSIDERED FINAL
UNLESS ALL SIGNATURES COMPLETED

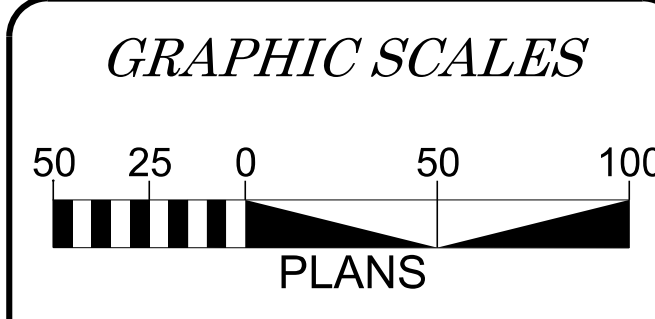

PROJECT LENGTH

TOTAL LENGTH OF TIP PROJECT HS-2014AD = 0.112 MILES

Prepared in the Office of:
DIVISION OF HIGHWAYS
253 Webster Rd., Sylva NC, 28779

2024 STANDARD SPECIFICATIONS

RIGHT OF WAY DATE: N/A

LETTING DATE: SEPTEMBER 9, 2025

JAMES HOLLINGSWORTH, PE
PROJECT ENGINEER

JAMES HOLLINGSWORTH, PE
PROJECT DESIGN ENGINEER

HYDRAULICS ENGINEER

7/7/2025

DocuSigned by:
James Hollingsworth
SIGNATURE: P.E.

ROADWAY DESIGN ENGINEER

7/7/2025

DocuSigned by:
James Hollingsworth
SIGNATURE: P.E.

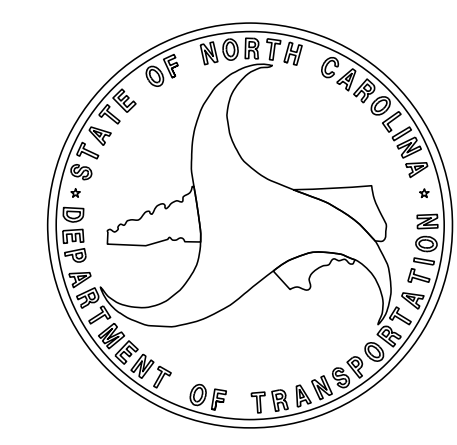

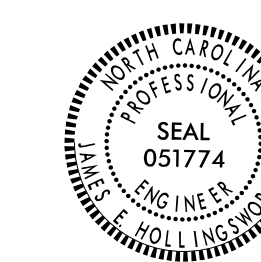
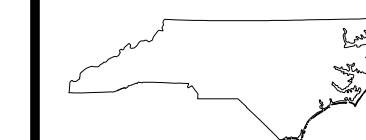

EFF. 01-16-2024
REV.

2024 ROADWAY ENGLISH STANDARD DRAWINGS

The following Roadway Standards as appear in "Roadway Standard Drawings" Contracts Standards and Development Unit - N. C. Department of Transportation - Raleigh, N. C., Dated January 16, 2024 are applicable to this project and by reference hereby are considered a part of these plans:

STD.NO. TITLE

DIVISION 3 - PIPE CULVERTS
300.01 Method of Pipe Installation

DIVISION 8 - INCIDENTALS
840.04 Concrete Open Throat Catch Basin - 12" thru 48" Pipe
840.55 Manhole Frame and Cover (Flush with Slab for Open Throat Catch Basin)
846.01 Concrete Curb, Gutter and Curb & Gutter
848.01 Concrete Sidewalk
848.02 Driveway Turnout - Radius Type
848.06 Curb Ramp

DIVISION 11 - WORK ZONE TRAFFIC CONTROL
1101.01 Work Zone Advance Warning Signs
1101.02 Temporary Lane Closures
1101.03 Temporary Road Closures
1101.04 Temporary Shoulder Closures
1101.05 Work Zone Vehicle Accesses
1101.06 Warning Signs for Blasting Zones
1101.11 Traffic Control Design Tables
1110.01 Stationary Work Zone Signs
1110.02 Portable Work Zone Signs
1115.01 Flashing Arrow Boards
1130.01 Drums
1135.01 Cones
1145.01 Barricades - Type III
1150.01 Flaggers
1160.01 Temporary Crash Cushion - Reflective End Treatment
1165.01 Truck Mounted Attenuator
1170.01 Portable Concrete Barrier
1180.01 Skinny Drums
DIVISION 12 - PAVEMENT MARKINGS, MARKERS AND DELINEATIONS
1205.01 Line Types and Offsets
1205.02 Two Lane and Multi Lane Roadways
1205.07 Pedestrian Crosswalks

GENERAL NOTES: 2024 SPECIFICATIONS
EFFECTIVE: 01-16-2024
REVISED:

GRADING AND SURFACING OR RESURFACING AND WIDENING:

THE GRADE LINES SHOWN DENOTE THE FINISHED ELEVATION OF THE PROPOSED SURFACING AT GRADE POINTS SHOWN ON THE TYPICAL SECTIONS. WHERE NO GRADE LINES ARE SHOWN, THE PROFILES SHOWN DENOTE THE TOP ELEVATION OF THE EXISTING PAVEMENT ALONG THE CENTER LINE OF SURVEY ON WHICH THE PROPOSED RESURFACING WILL BE PLACED. GRADE LINES MAY BE ADJUSTED BY THE ENGINEER IN ORDER TO SECURE A PROPER TIE-IN.

SIDE ROADS:

THE CONTRACTOR WILL BE REQUIRED TO DO ALL NECESSARY WORK TO PROVIDE SUITABLE CONNECTIONS WITH ALL ROADS, STREETS, AND DRIVES ENTERING THIS PROJECT. THIS WORK WILL BE PAID FOR AT THE CONTRACT UNIT PRICE FOR THE PARTICULAR ITEMS INVOLVED.

DRIVEWAYS:

DRIVEWAYS SHALL BE CONSTRUCTED IN ACCORDANCE WITH STD. 848.02 USING 3 FOOT RADII OR RADII AS SHOWN ON THE PLANS. LOCATIONS OF DRIVES WILL BE AS SHOWN ON THE PLANS OR AS DIRECTED BY THE ENGINEER.

UTILITIES:

ANY RELOCATION OF EXISTING UTILITIES WILL BE ACCOMPLISHED BY OTHERS, EXCEPT AS SHOWN ON THE PLANS.

CURB RAMPS

CURB RAMPS ARE SHOWN ON THE PLANS AT APPROXIMATE LOCATIONS. CONSTRUCT ALL CURB RAMPS ACCORDANCE WITH STD 848.06.

INDEX OF SHEETS

SHEET NUMBER	SHEET
1	TITLE SHEET
1A	INDEX OF SHEETS, GENERAL NOTES, AND STANDARD DRAWINGS
1B	CONVENTIONAL SYMBOLS
2A	PAVEMENT SCHEDULE AND TYPICAL SECTIONS
3B	ROADWAY AND DRAINAGE SUMMARIES
4	PLAN SHEET
EC-1 THRU EC-4	EROSION CONTROL PLANS
X-1 THRU X-4	CROSS-SECTIONS

Note: Not to Scale

STATE OF NORTH CAROLINA, DIVISION OF HIGHWAYS CONVENTIONAL PLAN SHEET SYMBOLS

HS-2014AD
IB

BOUNDARIES AND PROPERTY:

State Line	-----
County Line	-----
Township Line	-----
City Line	-----
Reservation Line	-----
Property Line	-----
Existing Iron Pin (EIP)	○ EIP
Computed Property Corner	×
Existing Concrete Monument (ECM)	◻ ECM
Parcel / Sequence Number	⑫③
Existing Fence Line	-x-x-x-
Proposed Woven Wire Fence	○
Proposed Chain Link Fence	▣
Proposed Barbed Wire Fence	◇
Existing Wetland Boundary	---WLB---
Proposed Wetland Boundary	---WLB---
Existing Endangered Animal Boundary	---EAB---
Existing Endangered Plant Boundary	---EPB---
Existing Historic Property Boundary	---HPB---
Known Contamination Area: Soil	---S---S---
Potential Contamination Area: Soil	---S---S---
Known Contamination Area: Water	---W---W---
Potential Contamination Area: Water	---W---W---
Contaminated Site: Known or Potential	☠ ?

BUILDINGS AND OTHER CULTURE:

Gas Pump Vent or U/G Tank Cap	○
Sign	○ S
Well	○ W
Small Mine	✕
Foundation	▭
Area Outline	▭
Cemetery	▭ +
Building	▭
School	▭
Church	▭
Dam	▭

HYDROLOGY:

Stream or Body of Water	-----
Hydro, Pool or Reservoir	▭
Jurisdictional Stream	---JS---
Buffer Zone 1	---BZ 1---
Buffer Zone 2	---BZ 2---
Flow Arrow	←
Disappearing Stream	→
Spring	○
Wetland	▭
Proposed Lateral, Tail, Head Ditch	---FLW---
False Sump	▭

RAILROADS:

Standard Gauge	-----
RR Signal Milepost	○ MILEPOST 35
Switch	▭ SWITCH
RR Abandoned	-----
RR Dismantled	-----

RIGHT OF WAY & PROJECT CONTROL:

Primary Horiz Control Point	○
Primary Horiz and Vert Control Point	●
Secondary Horiz and Vert Control Point	◆
Vertical Benchmark	⊠
Existing Right of Way Monument	△
Proposed Right of Way Monument (Rebar and Cap)	▲
Proposed Right of Way Monument (Concrete)	⊙
Existing Permanent Easement Monument	◇
Proposed Permanent Easement Monument (Rebar and Cap)	◇
Existing C/A Monument	△
Proposed C/A Monument (Rebar and Cap)	▲
Proposed C/A Monument (Concrete)	⊙
Existing Right of Way Line	-----
Proposed Right of Way Line	-----
Existing Control of Access Line	-----
Proposed Control of Access Line	-----
Proposed ROW and CA Line	-----
Existing Easement Line	-----
Proposed Temporary Construction Easement	-----
Proposed Temporary Drainage Easement	-----
Proposed Permanent Drainage Easement	-----
Proposed Permanent Drainage/Utility Easement	-----
Proposed Permanent Utility Easement	-----
Proposed Temporary Utility Easement	-----
Proposed Aerial Utility Easement	-----

ROADS AND RELATED FEATURES:

Existing Edge of Pavement	-----
Existing Curb	-----
Proposed Slope Stakes Cut	---C---
Proposed Slope Stakes Fill	---F---
Proposed Curb Ramp	CR
Existing Metal Guardrail	T T T T
Proposed Guardrail	T T T T
Existing Cable Guiderail	▭ ▭ ▭
Proposed Cable Guiderail	▭ ▭ ▭
Equality Symbol	⊙
Pavement Removal	▭

VEGETATION:

Single Tree	☼
Single Shrub	☼
Hedge	-----

Woods Line	-----
Orchard	☼ ☼ ☼ ☼
Vineyard	▭ Vineyard

EXISTING STRUCTURES:

MAJOR:	
Bridge, Tunnel or Box Culvert	▭ CONC
Bridge Wing Wall, Head Wall and End Wall	▭ CONC WW
MINOR:	
Head and End Wall	▭ CONC HW
Pipe Culvert	-----
Footbridge	-----
Drainage Box: Catch Basin, DI or JB	▭ CB
Paved Ditch Gutter	-----
Storm Sewer Manhole	⊙
Storm Sewer	-----

UTILITIES:

* SUE - Subsurface Utility Engineering
LOS - Level of Service - A, B, C or D (Accuracy)

POWER:	
Existing Power Pole	●
Proposed Power Pole	○
Existing Joint Use Pole	●
Proposed Joint Use Pole	○
Power Manhole	⊙
Power Line Tower	⊠
Power Transformer	⊠
U/G Power Cable Hand Hole	⊠
H-Frame Pole	●
U/G Power Line Test Hole (SUE - LOS A)*	⊙
U/G Power Line (SUE - LOS B)*	-----
U/G Power Line (SUE - LOS C)*	-----
U/G Power Line (SUE - LOS D)*	-----

TELEPHONE:

Existing Telephone Pole	●
Proposed Telephone Pole	○
Telephone Manhole	⊙
Telephone Pedestal	⊠
Telephone Cell Tower	⊠
U/G Telephone Cable Hand Hole	⊠
U/G Telephone Test Hole (SUE - LOS A)*	⊙
U/G Telephone Cable (SUE - LOS B)*	-----
U/G Telephone Cable (SUE - LOS C)*	-----
U/G Telephone Cable (SUE - LOS D)*	-----
U/G Telephone Conduit (SUE - LOS B)*	-----
U/G Telephone Conduit (SUE - LOS C)*	-----
U/G Telephone Conduit (SUE - LOS D)*	-----
U/G Fiber Optics Cable (SUE - LOS B)*	-----
U/G Fiber Optics Cable (SUE - LOS C)*	-----
U/G Fiber Optics Cable (SUE - LOS D)*	-----

WATER:

Water Manhole	⊙
Water Meter	○
Water Valve	⊗
Water Hydrant	⊙
U/G Water Line Test Hole (SUE - LOS A)*	⊙
U/G Water Line (SUE - LOS B)*	-----
U/G Water Line (SUE - LOS C)*	-----
U/G Water Line (SUE - LOS D)*	-----
Above Ground Water Line	-----

TV:

TV Pedestal	⊠
TV Tower	⊗
U/G TV Cable Hand Hole	⊠
U/G TV Test Hole (SUE - LOS A)*	⊙
U/G TV Cable (SUE - LOS B)*	-----
U/G TV Cable (SUE - LOS C)*	-----
U/G TV Cable (SUE - LOS D)*	-----
U/G Fiber Optic Cable (SUE - LOS B)*	-----
U/G Fiber Optic Cable (SUE - LOS C)*	-----
U/G Fiber Optic Cable (SUE - LOS D)*	-----

GAS:

Gas Valve	◇
Gas Meter	◇
U/G Gas Line Test Hole (SUE - LOS A)*	⊙
U/G Gas Line (SUE - LOS B)*	-----
U/G Gas Line (SUE - LOS C)*	-----
U/G Gas Line (SUE - LOS D)*	-----
Above Ground Gas Line	-----

SANITARY SEWER:

Sanitary Sewer Manhole	⊙
Sanitary Sewer Cleanout	⊕
U/G Sanitary Sewer Line	-----
Above Ground Sanitary Sewer	-----
SS Force Main Line Test Hole (SUE - LOS A)*	⊙
SS Force Main Line (SUE - LOS B)*	-----
SS Force Main Line (SUE - LOS C)*	-----
SS Force Main Line (SUE - LOS D)*	-----

MISCELLANEOUS:

Utility Pole	●
Utility Pole with Base	⊠
Utility Located Object	○
Utility Traffic Signal Box	⊠
Utility Unknown U/G Line (SUE - LOS B)*	-----
U/G Tank; Water, Gas, Oil	▭
Underground Storage Tank, Approx. Loc.	▭
A/G Tank; Water, Gas, Oil	▭
Geoenvironmental Boring	⊙
Abandoned According to Utility Records	AATUR
End of Information	E.O.I.

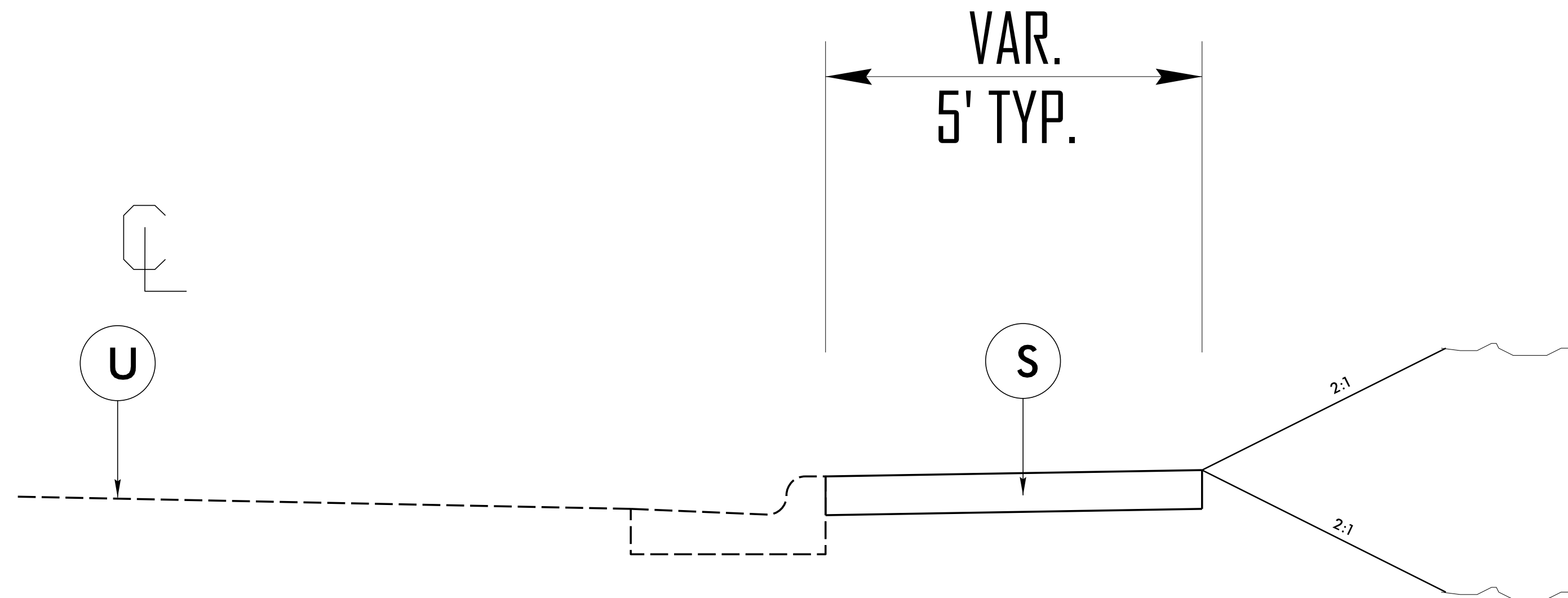

TYPICAL SECTION NO. 1

-L- STA 10+37 TO STA 13+74

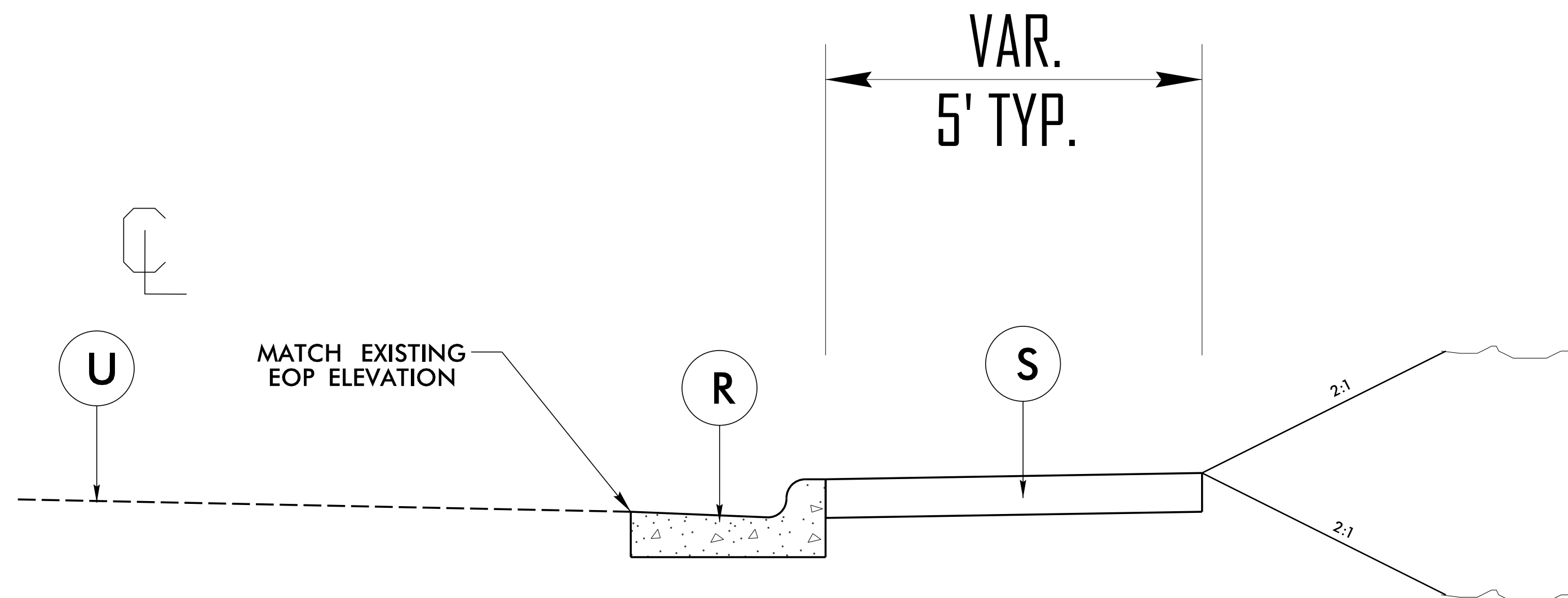

TYPICAL SECTION NO. 2

-L- STA 14+07 TO STA 15+61

PAVEMENT SCHEDULE	
R	2' - 6" CONCRETE CURB AND GUTTER
S	4" CONCRETE SIDEWALK
U	EXISTING PAVEMENT

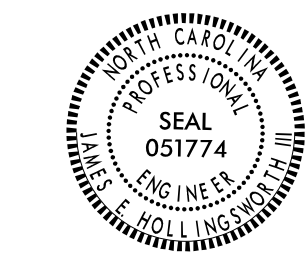
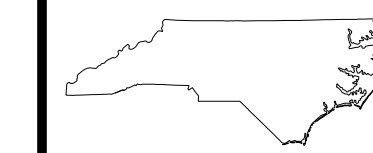

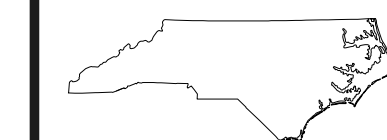

ROADWAY DESIGN UNIT
ROADWAY DESIGN ENGINEER



HYDRAULICS ENGINEER

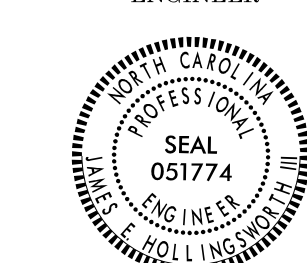

DOCUMENT NOT CONSIDERED FINAL UNLESS ALL SIGNATURES COMPLETED

CUR DATA -EL-
P/c 14+90.80
 $\Delta c = 07^{\circ}51'15.3''$ (LT)
 $D = 04^{\circ}05'33.1''$
 $Lc = 191.92$
 $Tc = 96.11$
 $R = 1,400.01$
 $SE = 0.000$

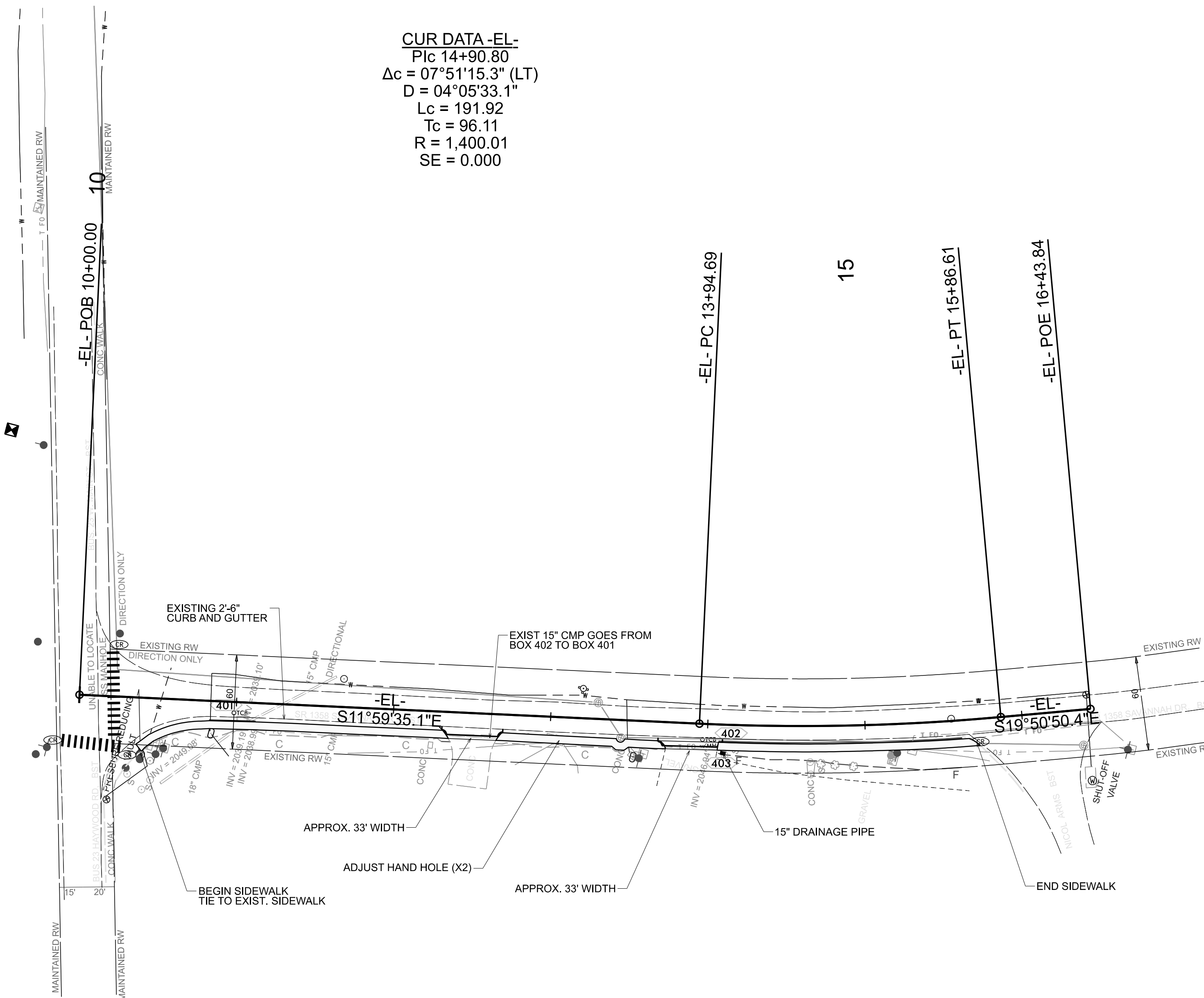

 PROP CONC SIDEWALK

TIP PROJECT: HS-2014AD

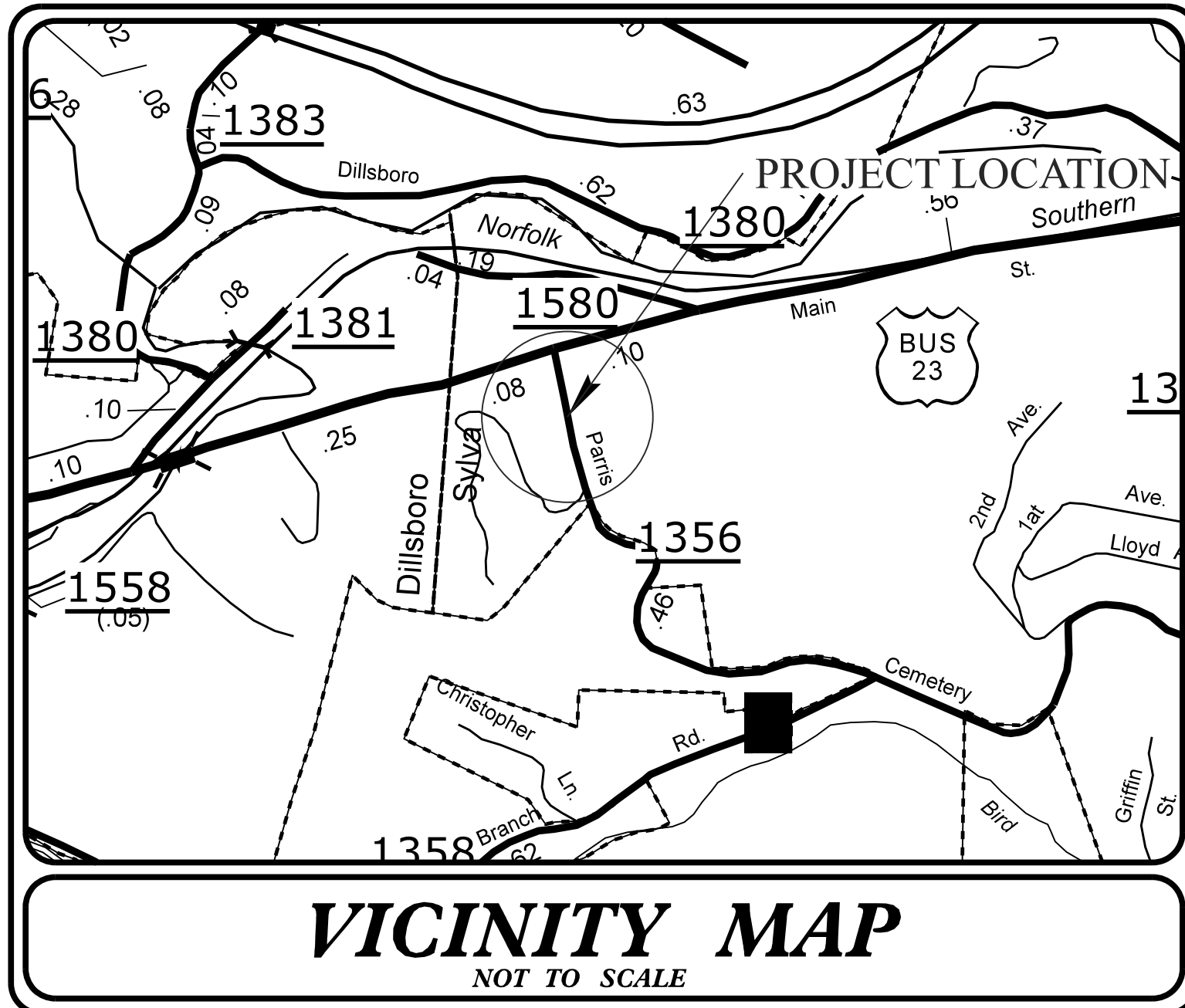

STATE OF NORTH CAROLINA
DIVISION OF HIGHWAYS

**PLAN FOR PROPOSED
HIGHWAY EROSION CONTROL**

JACKSON COUNTY

LOCATION: *SR 1356 (SAVANNAH DR) FROM US 23 BUS TO NICOL ARMS RD*
TYPE OF WORK: *SIDEWALK, CURB RAMPS,
PAVEMENT MARKINGS*

STATE	STATE PROJECT REFERENCE NO.	SHEET NO.	TOTAL SHEETS
N.C.	HS-2014AD	EC-1	
STATE PROJ. NO.	P.A. PROJ. NO.	DESCRIPTION	

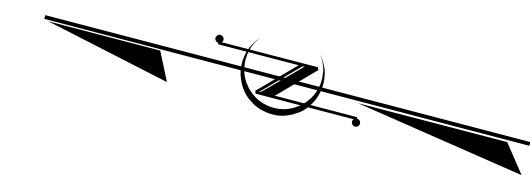

THIS PROJECT HAS
BEEN DESIGNED TO
SENSITIVE WATERSHED
STANDARDS.

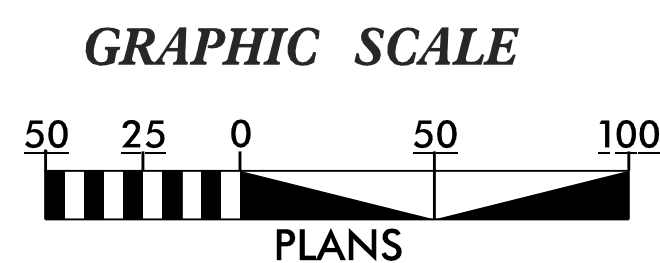

THESE EROSION AND SEDIMENT CONTROL PLANS COMPLY
WITH THE REGULATIONS SET FORTH BY THE
NCG-010000 GENERAL STORMWATER CONSTRUCTION PERMIT
ISSUED BY THE NORTH CAROLINA DEPARTMENT OF
ENVIRONMENTAL QUALITY DIVISION OF ENERGY,
MINERAL, AND LAND RESOURCES.

Prepared in the Office of:
DIVISION OF HIGHWAYS
253 Webster Rd.
Sylva, NC 28779
2024 STANDARD SPECIFICATIONS

Designed by:
DREW RIVENBARK, EI **4342**
NAME LEVEL III CERTIFICATION NO.

Roadway Standard Drawings
The "Roadway Standard Drawings"- Roadway Design Unit - N. C. Department of Transportation - Raleigh, N. C., dated January 2024 and the latest revision thereto are applicable to this project and by reference hereby are considered a part of these plans.

DIVISION OF HIGHWAYS STATE OF NORTH CAROLINA

PROJECT REFERENCE NO. HS-2014AD	SHEET NO. EC-02
ROADWAY DESIGN ENGINEER	HYDRAULICS ENGINEER

EROSION & SEDIMENT CONTROL LEGEND

Std. #	Description	Symbol	Std. #	Description	Symbol
1605.01	Temporary Silt Fence		1633.01	Temporary Rock Silt Check Type A	
1606.01	Special Sediment Control Fence		1633.02	Temporary Rock Silt Check Type B	
1622.01	Temporary Berms and Slope Drains		1633.03	Temporary Rock Silt Check Type A with Excelsior Matting and Flocculant	
1630.02	Silt Basin Type B		1634.01	Temporary Rock Sediment Dam Type A	
1630.03	Temporary Silt Ditch		1634.02	Temporary Rock Sediment Dam Type B	
1630.04	Stilling Basin		1635.01	Rock Pipe Inlet Sediment Trap Type A	
1630.05	Temporary Diversion		1635.02	Rock Pipe Inlet Sediment Trap Type B	
1630.06	Special Stilling Basin		1636.01	Excelsior Wattle Check	
1630.07	Skimmer Basin		1636.01	Excelsior Wattle Check with Flocculant	
1630.08	Tiered Skimmer Basin		1636.01	Coir Fiber Wattle Check	
1630.09	Earthen Dam with Skimmer		1636.01	Coir Fiber Wattle Check with Flocculant	
	Infiltration Basin		1636.02	Silt Fence Excelsior Wattle Break	
	Rock Inlet Sediment Trap:			Silt Fence Coir Fiber Wattle Break	
1632.01	Type A		1636.03	Excelsior Wattle Barrier	
1632.02	Type B		1636.03	Coir Fiber Wattle Barrier	
1632.03	Type C				

PROJECT REFERENCE NO.	SHEET NO.
HS-2014AD	EC-3A
RW SHEET NO.	
ROADWAY DESIGN ENGINEER	HYDRAULICS ENGINEER

ONSITE CONCRETE WASHOUT STRUCTURE WITH LINER

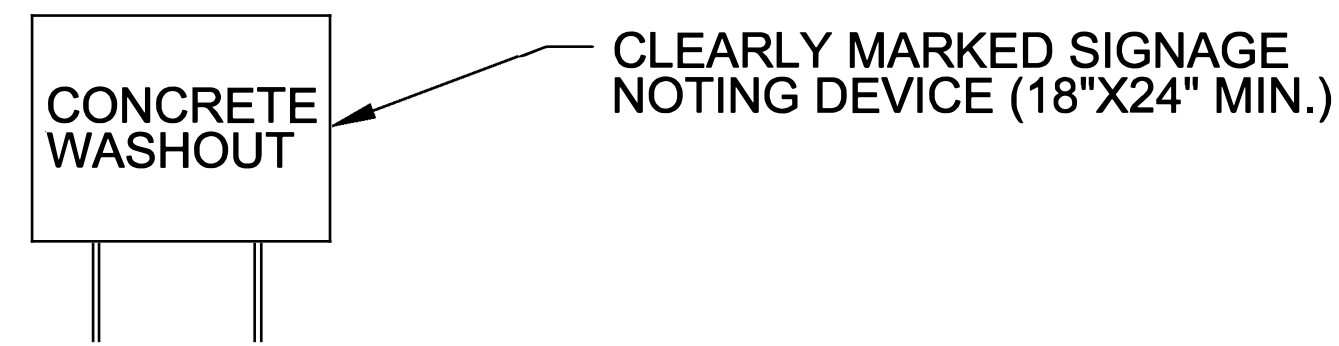
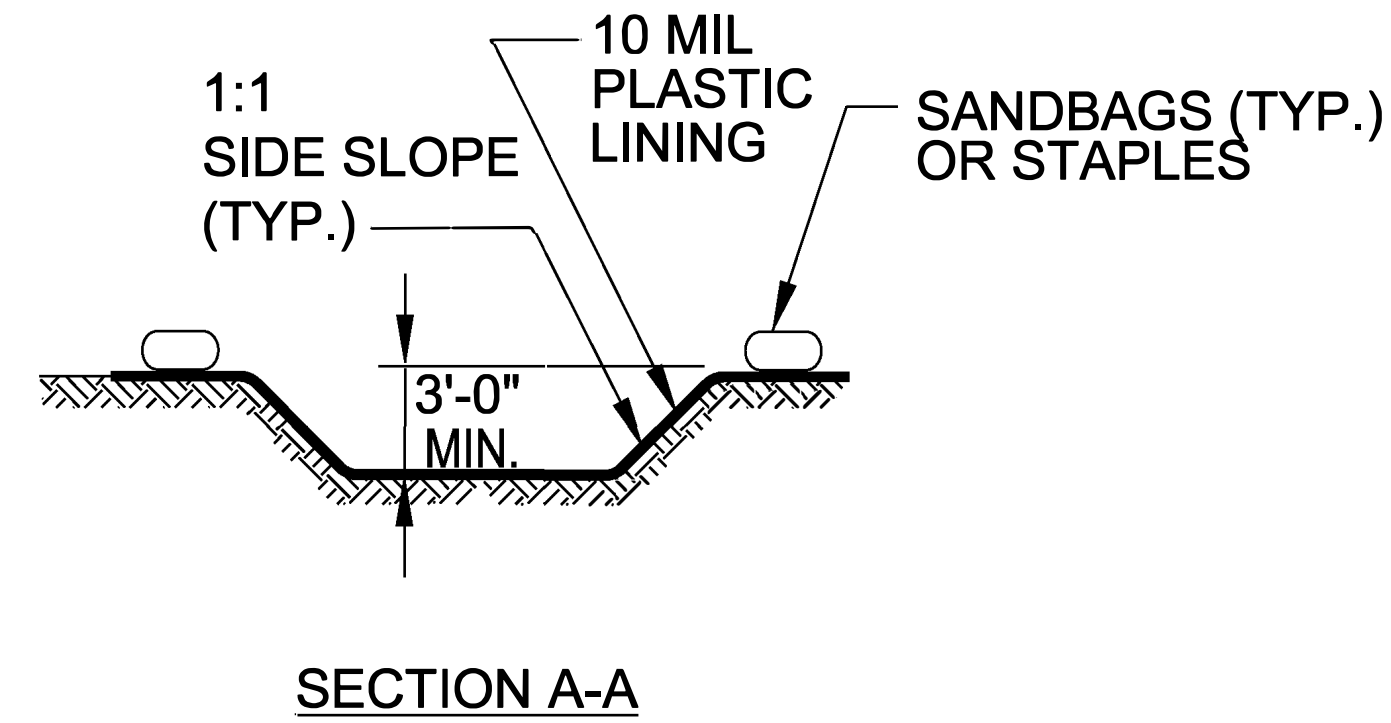
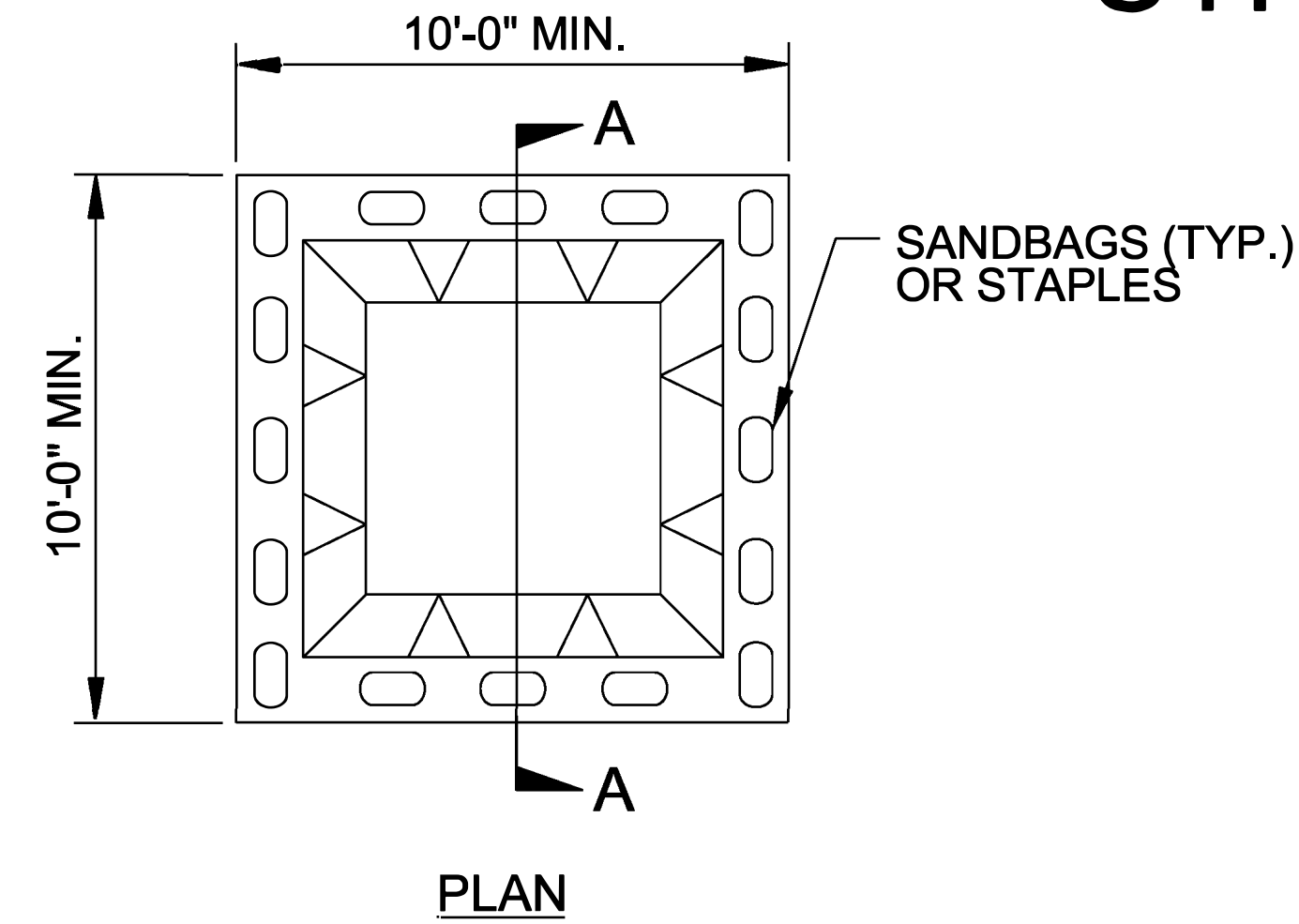

BELOW GRADE WASHOUT STRUCTURE
NOT TO SCALE

- NOTES:**
1. ACTUAL LOCATION DETERMINED IN FIELD
 2. THE CONCRETE WASHOUT STRUCTURES SHALL BE MAINTAINED WHEN THE LIQUID AND/OR SOLID REACHES 75% OF THE STRUCTURES CAPACITY TO PROVIDE ADEQUATE HOLDING CAPACITY WITH A MINIMUM 12 INCHES OF FREEBOARD.
 3. CONCRETE WASHOUT STRUCTURE NEEDS TO BE CLEARLY MARKED WITH SIGNAGE NOTING DEVICE.

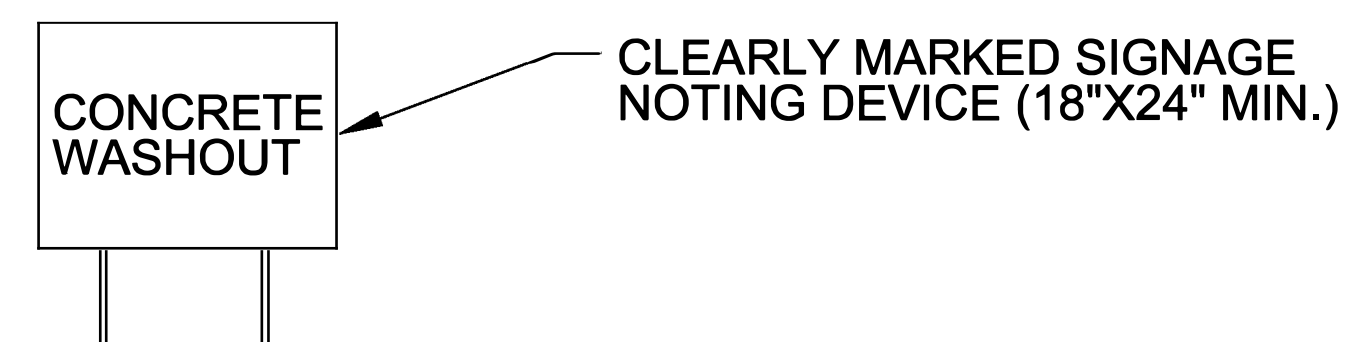
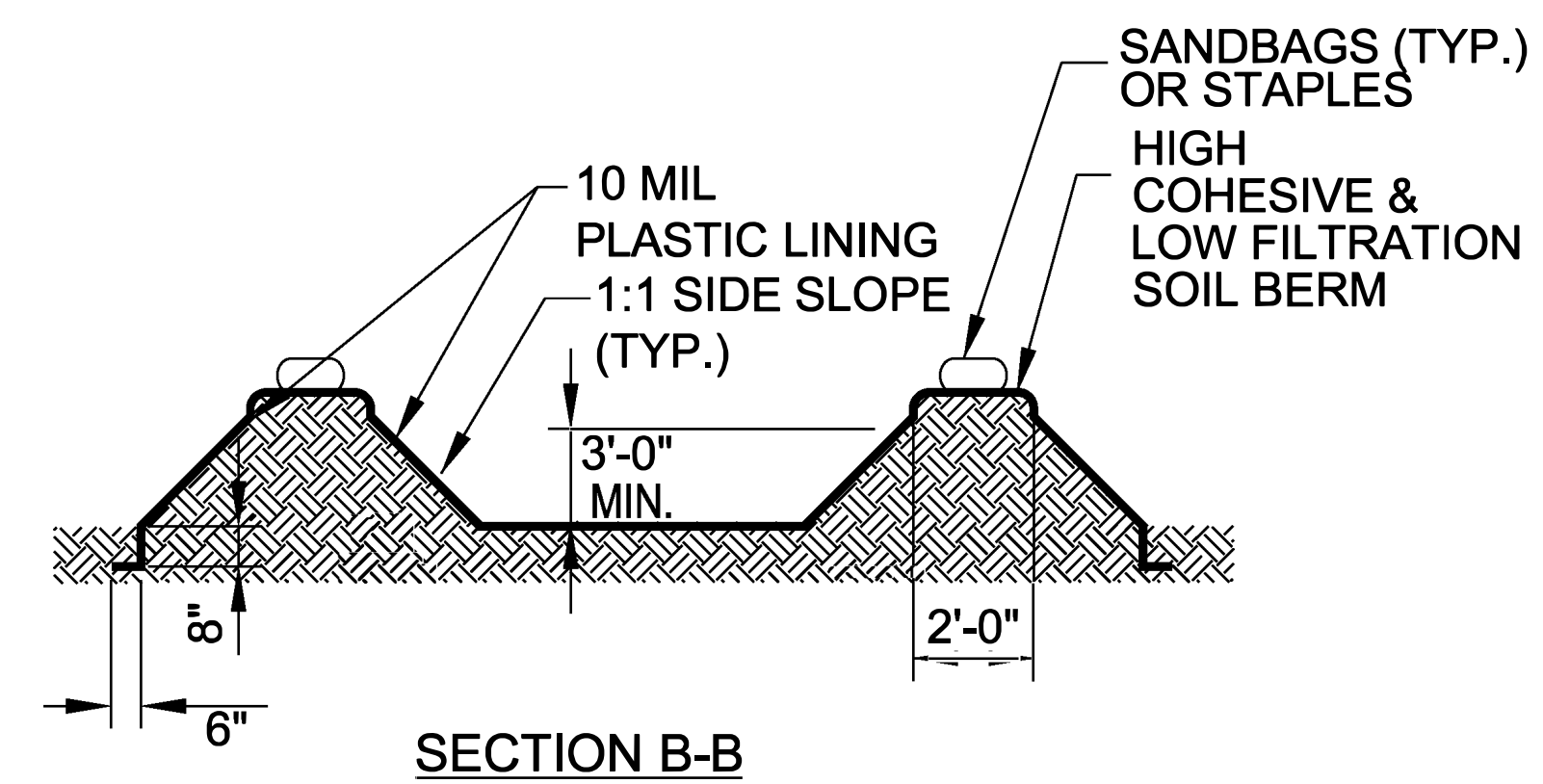
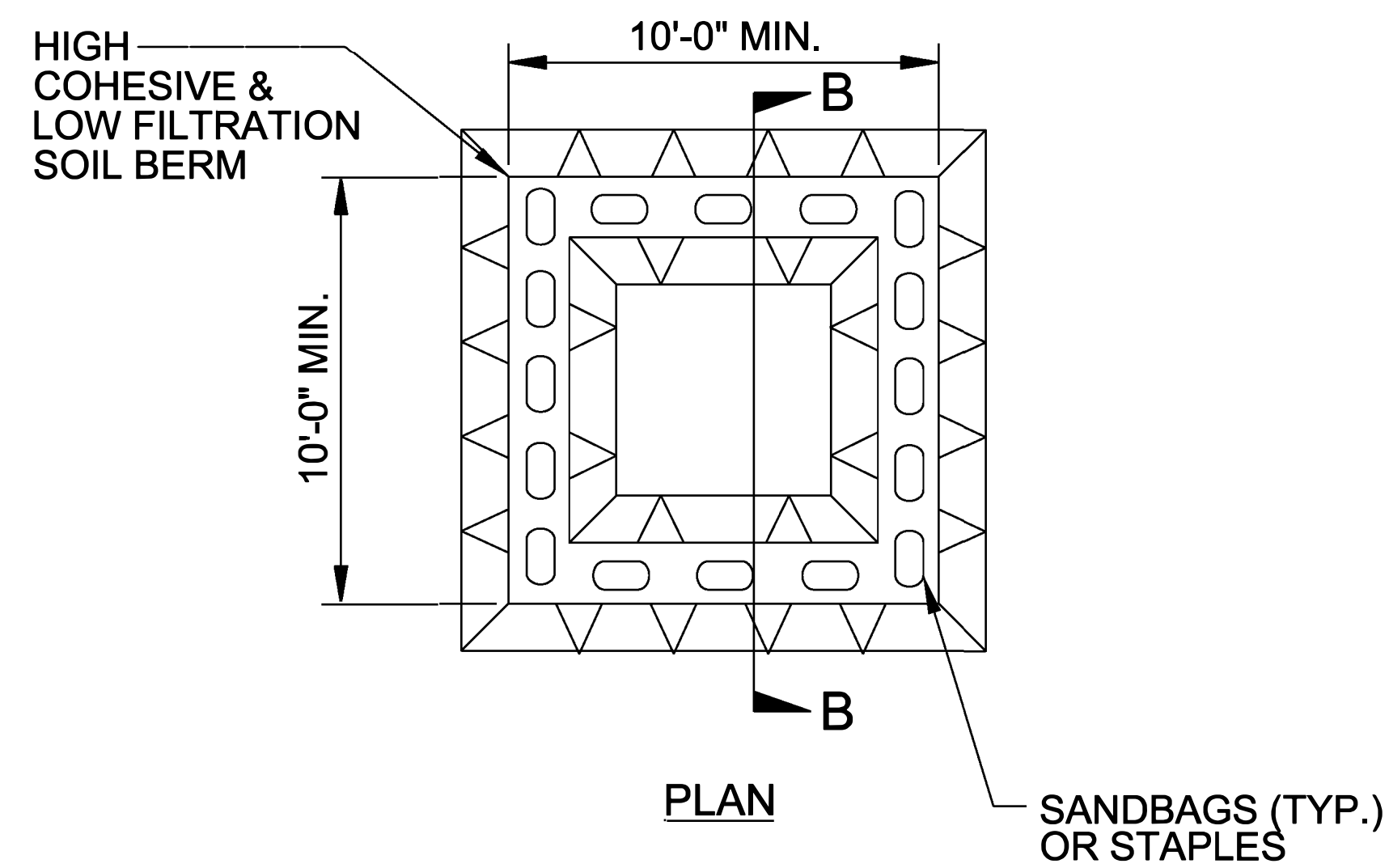

ABOVE GRADE WASHOUT STRUCTURE
NOT TO SCALE

- NOTES:**
1. ACTUAL LOCATION DETERMINED IN FIELD
 2. THE CONCRETE WASHOUT STRUCTURES SHALL BE MAINTAINED WHEN THE LIQUID AND/OR SOLID REACHES 75% OF THE STRUCTURES CAPACITY TO PROVIDE ADEQUATE HOLDING CAPACITY WITH A MINIMUM 12 INCHES OF FREEBOARD.
 3. CONCRETE WASHOUT STRUCTURE NEEDS TO BE CLEARLY MARKED WITH SIGNAGE NOTING DEVICE.

DIVISION OF HIGHWAYS
STATE OF NORTH CAROLINA

PROJECT REFERENCE NO. <i>HS-2014AD</i>	SHEET NO. <i>EC-3B</i>
ROADWAY DESIGN ENGINEER	HYDRAULICS ENGINEER

SOIL STABILIZATION TIMEFRAMES

<i>SITE DESCRIPTION</i>	<i>STABILIZATION TIME</i>	<i>TIMEFRAME EXCEPTIONS</i>
PERIMETER DIKES, SWALES, DITCHES AND SLOPES	7 DAYS	NONE
HIGH QUALITY WATER (HQW) ZONES	7 DAYS	NONE
SLOPES STEEPER THAN 3:1	7 DAYS	IF SLOPES ARE 10' OR LESS IN LENGTH AND ARE NOT STEEPER THAN 2:1, 14 DAYS ARE ALLOWED.
SLOPES 3:1 TO 4:1	14 DAYS	7 DAYS FOR SLOPES GREATER THAN 50' IN LENGTH WITH SLOPES STEEPER THAN 4:1. 7 DAYS FOR PERIMETER DIKES, SWALES, DITCHES PERIMETER SLOPES, AND HQW ZONES
ALL OTHER AREAS WITH SLOPES FLATTER THAN 4:1	14 DAYS	7 DAYS FOR PERIMETER DIKES, SWALES, DITCHES PERIMETER SLOPES, AND HQW ZONES

CUR DATA -EL-
P/c 14+90.80
 $\Delta c = 07^{\circ}51'15.3''$ (LT)
 $D = 04^{\circ}05'33.1''$
 $L_c = 191.92$
 $T_c = 96.11$
 $R = 1,400.01$
 $SE = 0.000$

